

B Sp. Bldg/130/2002
Planning Permit No.
APPROVED
SUBJECT TO THE CONDITIONS IN THIS OFFICE LETTER.
Rd/25870/9, Date: 02-03
FOR MEMBER SECRETARY, CHENNAI METROPOLITAN DEVELOPMENT AUTHORITY, CHENNAI-600 008.

CMDA (B) No. 1
C. No. B/135/890/2002
Asst. Secretary
Scrutiny P.A. [Signature]
A.P. [Signature] D.P. [Signature]

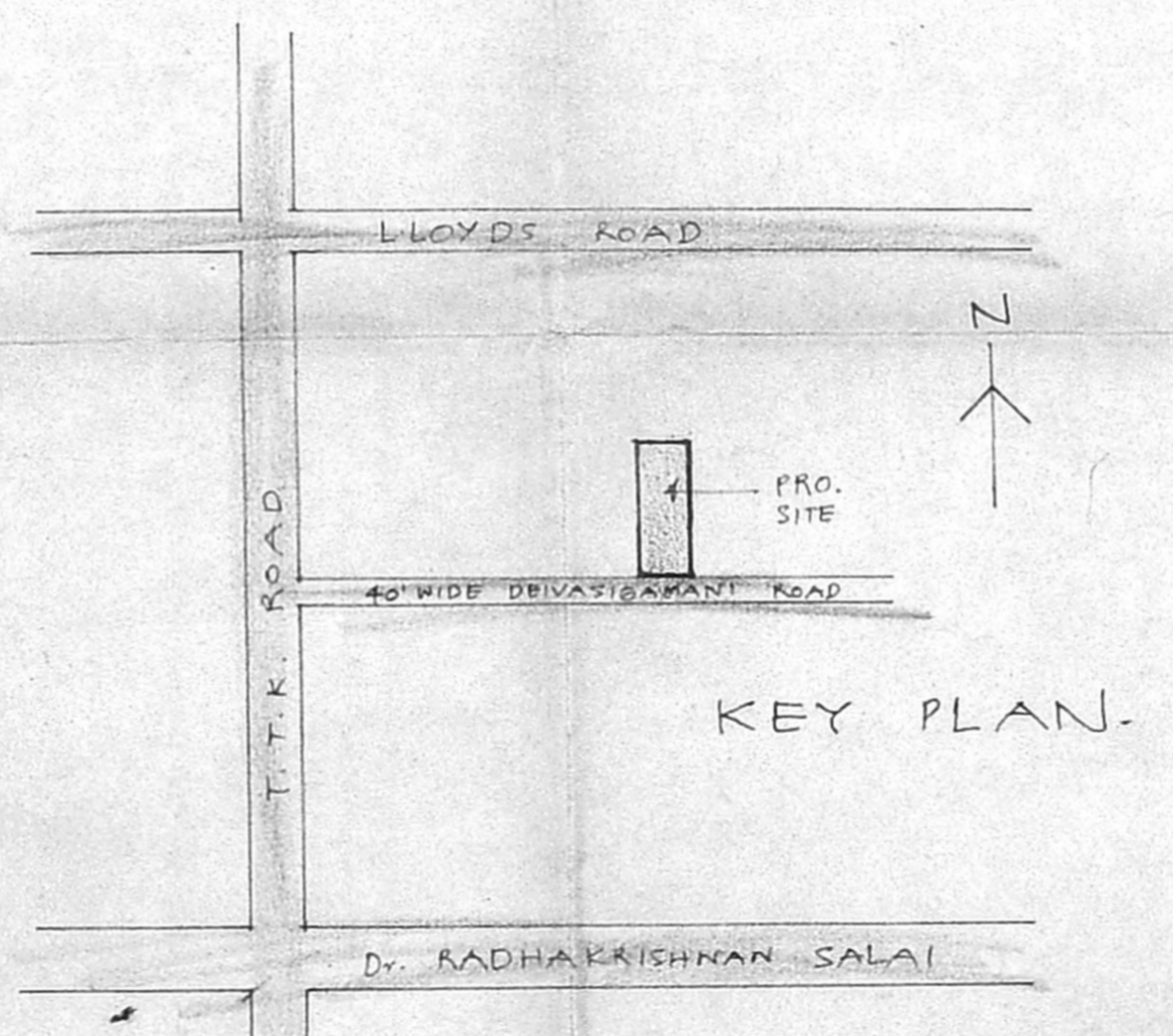

SCHEDULE OF JOINERY

D1	3'6" x 7'0"	T.W. FLUSH DOOR.
D2	3'6" x 7'0"	T.W. FLUSH DOOR.
D3	2'6" x 7'0"	T.W. FLUSH DOOR.
W1	6'0" x 4'6"	T.W. GLAZED WINDOW.
W2	4'6" x 4'6"	T.W. GLAZED WINDOW.
W3	3'6" x 4'6"	T.W. GLAZED WINDOW.
V1	2'0" x 2'0"	A.C. JALI

STATEMENT OF BUILT UP AREA

GROUND FLOOR AREA	: 181.25 m ²
FIRST FLOOR AREA	: 198.49 m ²
SECOND FLOOR AREA	: 198.44 m ²
THIRD FLOOR AREA	: 198.44 m ²
TOTAL AREA	: 776.62 m²

PLOT AREA : 550.06 m² AS PER PATTI.
503.9 m² AS PER DOCUMENT.
FSI : 1.41. COVERAGE : 36%.

PROPOSED RESIDENTIAL BUILDING AT NO. G, OLD NO. 31, DEIVASIGAMANI ROAD, LAKSHMI PURAM, ROYAPETTAH, CHENNAI 600014. R.S. NO. 1149/9 BLOCK NO. 24 OF MYLAPORE.

T. SADASIVAM
T. MANGALAM
T. RAMASIVAM
T. RADAKRISHNAN
T. GOPALAKRISHNAN
T. JEETI SURESHANIAN

Signature of Owners

G. R. NAYAGAM
CLASS-I LICENSED SURVEYOR
No. 538/2002 - 2003,
CORPORATION OF CHENNAI
101, (B1) Uman Rd., 484 1996

Signature of Licensed Surveyor